

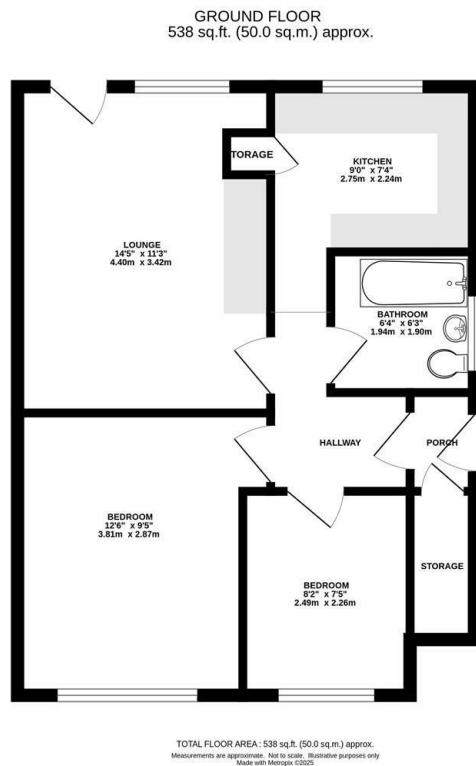

Keith
Ashton

Rayleigh Road, Hutton
Brentwood



309 Rayleigh Road, Hutton, Brentwood, CM13 1PL

****Guide Price £265,000 - £270,000**** We are pleased to present this well-proportioned ground-floor maisonette, offered with no onward chain and located in the sought-after area of Hutton.

The accommodation comprises a spacious lounge, a well-appointed kitchen, two generously sized double bedrooms, and a modern bathroom, all complemented by ample storage. This property also benefits from both front and rear gardens, providing welcoming and versatile outdoor spaces.

Conveniently situated just over a mile from Shenfield Station, the property offers an ideal blend of comfort, convenience, and excellent connectivity.



Guide Price £265,000 - £270,000

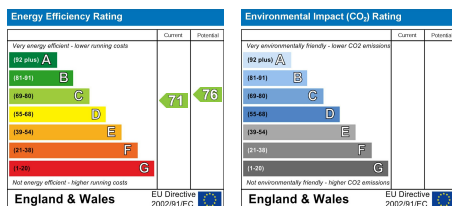

SERVICES:

Local Authority: Brentwood
Council tax band: C
Post code: CM13 1PL

VIEWING:

Strictly by prior arrangement with Keith Ashton Estate Agents

OPENING HOURS:

Monday to Friday: 8.45AM - 6.30PM | Saturdays: 9AM - 5.30PM | Sundays: 10AM - 2PM

MORTGAGE INFORMATION:

We offer the additional facility of an in-house Independent Financial Adviser who will access all mortgage lenders with the purpose of providing you with the benefit of choice. For quotations or comparables please call 01277 260858 or visit our interactive website at www.mortgagebusiness.net



We the Agent have not tested any apparatus, fittings or services for this property. The plot size is intended merely as a guide and has not been officially measured or verified by the Agent. Photographs are for illustration only and may depict items which are not for sale or included in the sale of the property. As part of the service we offer we may recommend ancillary services to you which we believe may help you with your property transaction. We wish to make you aware, that should you decide to use these services we will receive a referral fee. For full and detailed information please visit 'terms and conditions' on our website www.keithashton.co.uk

Brentwood
Tel. 01277 260858

Village Office
Tel. 01277 375757

Lettings Office
Tel. 01277 202200

Explore more @ www.keithashton.co.uk

